

Setup your new Windows 10 device

1. Start up your Windows 10 device and go through the first steps of the setup by choosing your language (recommended language is English), region and keyboard (recommended is United States-International) layout.
2. After this, Windows asks you to connect to a WiFi network, if you have not yet connected your device to the internet via cable.

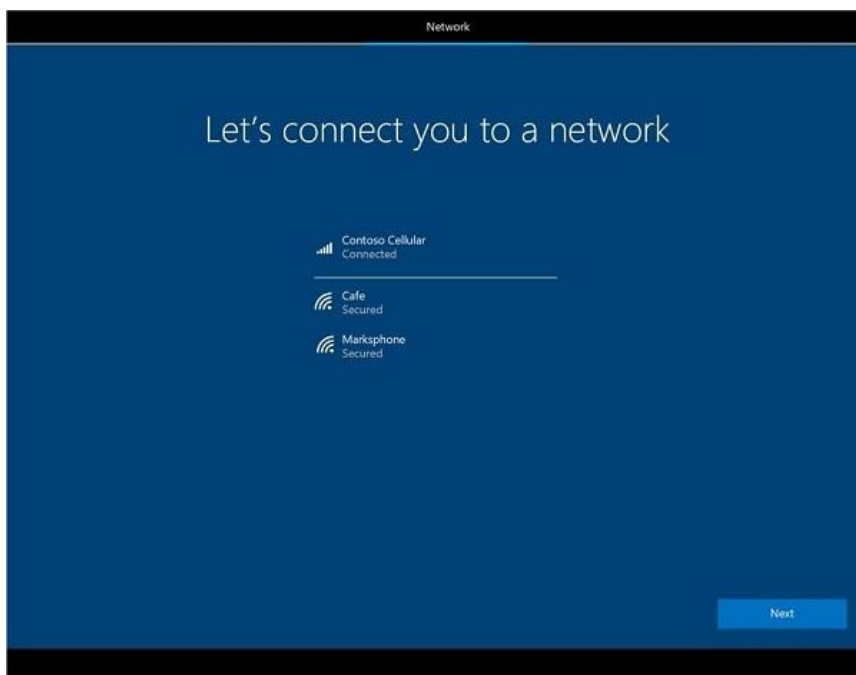

3. Next the computer will ask you how to set up, choose "Set up for an organization".

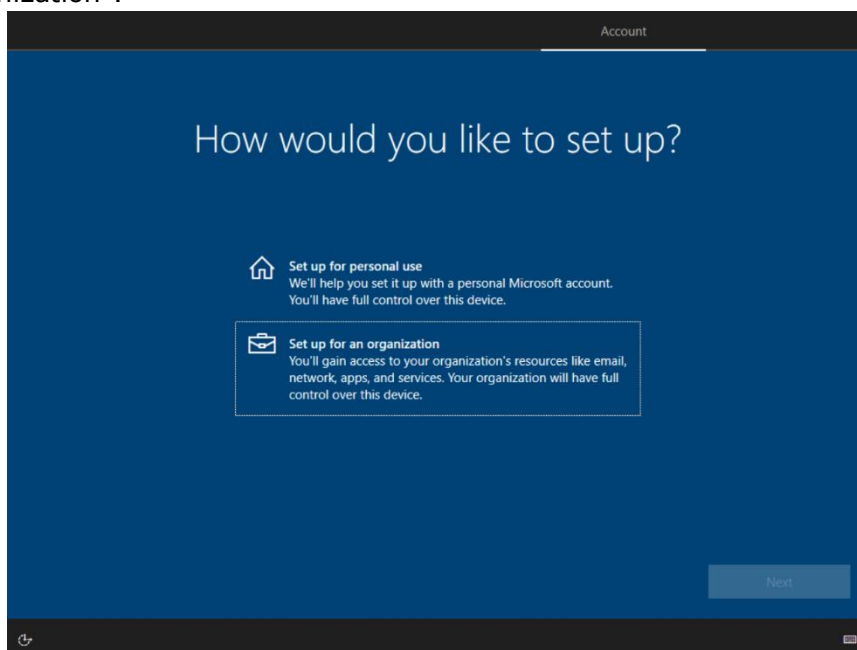

- Now you will be able to sign in using your Agriterra email.

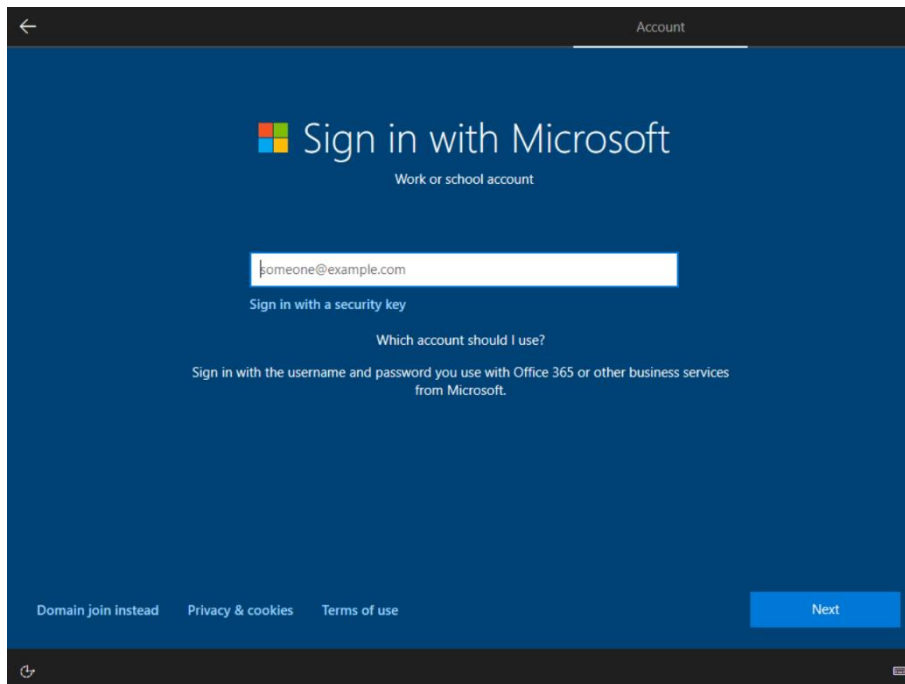

- After the login screen it will continue to setup the device.

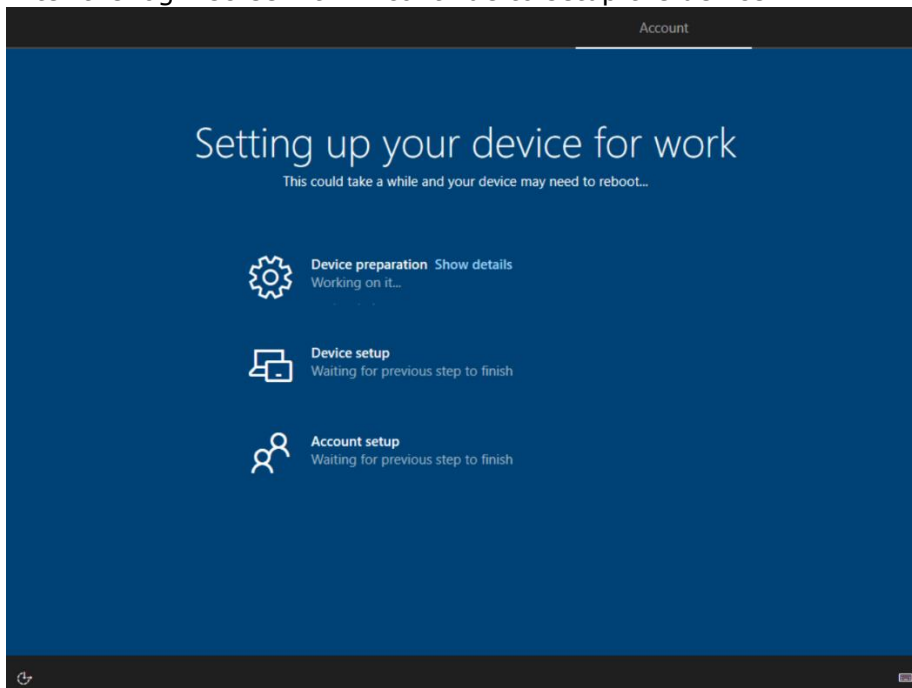

- When the setup process is finished you get a few more questions which you can choose to your liking. And eventually you get the login screen to login to the desktop for the first time. It will take a little while the first time and you might see the setup screen again finishing some last steps. Once you are in the desktop the laptop is ready to use.